



TSL - Trust Your Senses to a Proven Partner



COMBIKEY



Opening Buttons Combikey Series

GET CREATIVE
DESIGN YOUR OWN BUTTON



CONTENT

Highlights	5
Construction types	6-8
Color selection	9
Pictographs	10-13
Tactile surfaces	14-15
Light and sound signals	17
Configuration examples	18-19
Connectivity	20-21
Additional connectors and technical data	23

The Combikey button family of TSL ESCHA meets the highest requirements of durability with an unbreakable, robust housing construction. Since these buttons are used on road and rail transportation vehicles, they are exposed to most adverse environmental conditions. They are suitable for outdoor applications and thus steadily proven under frost, heat, dirt, and humidity.

In order to ensure maximum reliability, the Combikey buttons are manufactured with metal components. They are not only tested against graffiti removers but also resistant to aggressive cleaning chemicals. Furthermore, pictographs are proven against wear or vandalism.



Stainless steel button panel



Metal button surface



Pictograph



Transparent protective cover (PC)

Endless combinations of switching functions, touch surfaces, mounting rings, LED colors, and pictographs make the Combikey a versatile button family. Its great selection allows for the creation of personalized and extremely robust products. Since decades, buses, light rails, subways, and high-speed trains drive around the world with Combikey buttons that have proven high durability.

Thanks to the integrated microcontroller of high-tech electronics, a number of different functions can be easily implemented in Combikey buttons, including but not limited to blinking lights and sound sequences.

BUTTONS FOR STRICT REQUIREMENTS



ROBUST



Frost-resistant



Dustproof



Protection level IP67



Wear proof



Maintenance-free

INTERCHANGEABLE



Raised symbols
TSI PRM approved



Adjustable
sound signals



Adjustable
light signals



Vandal-resistant

Additional options



Resistant
to cleaning chemicals

HIGHLIGHTS AT A GLANCE

CONFIGURATION

CONSTRUCTION TYPES

Six different engineering designs of the Combikey Series allow this product family to be installed in various areas of application.



CONSTRUCTION TYPE 1

Function: Double-sided
 Description: Inner push button assembly on exterior button with screws. Wireless connection between the two buttons is possible thanks to a built-in connector with distance compensation
 Applications: Wall installation for three different wall thickness min. 29mm - max. 44mm

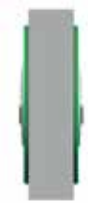

Wall installation

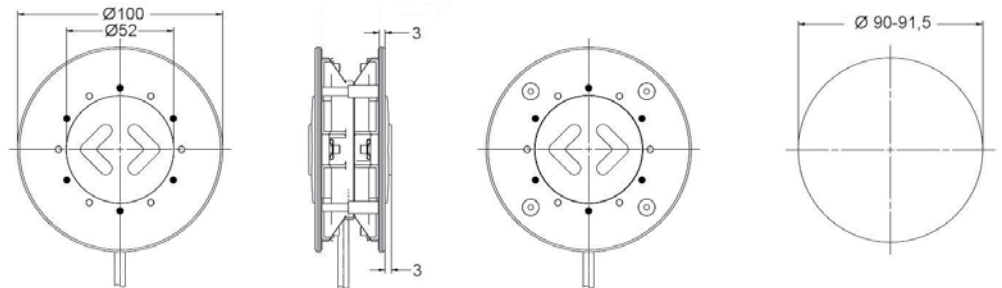

CONSTRUCTION TYPE 2

Function: Double-sided
 Description: Inner push button (pre-assembly with space ring) assembly on exterior button with screws. Wireless connection between the two buttons is possible thanks to a built-in connector with distance compensation
 Applications: Glass door, door thickness from 4mm - 8mm



Glass door installation with space ring

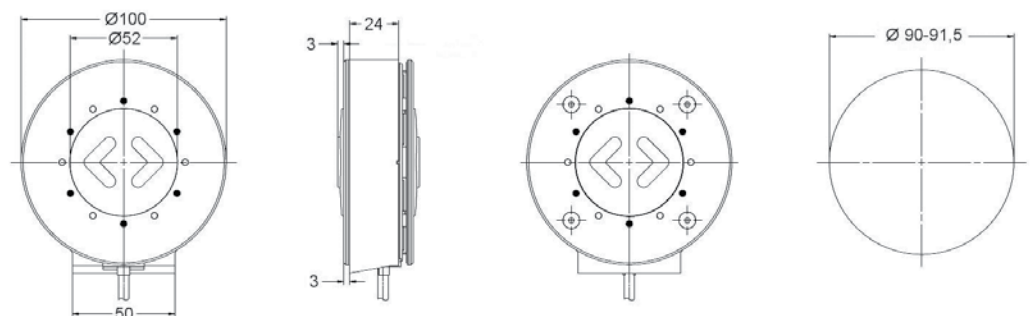

Configuration Status "Construction and Mounting Type"





CONSTRUCTION TYPE 3

Function: 1-sided

Description: Rear assembly with housing cover without visible front screws

Applications: Glass door, door thickness from 3.5mm - 6mm



Glass door installation

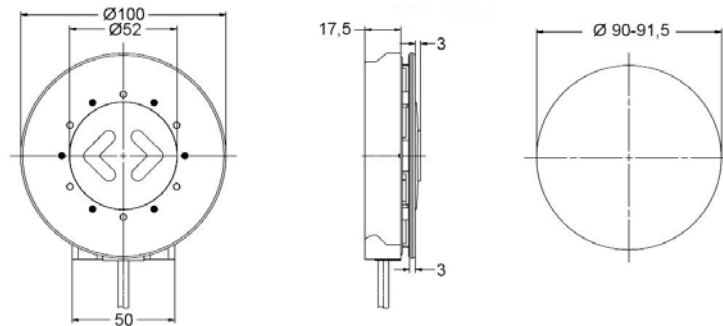

CONSTRUCTION TYPE 4

Function: 1-sided

Description: Front button assembly with Zentraflex fixing ring. Screw less flush-mounted installation

Applications: Exterior bus or wagon doors, door thickness 1.5mm (3mm upon request)



CK button with Zentraflex ring on wall

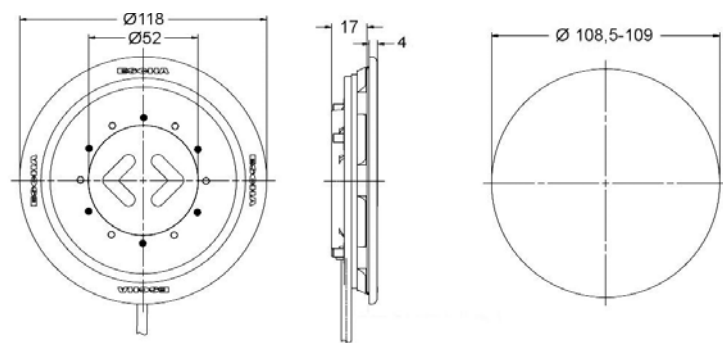

IT'S ALL ABOUT
THE DETAILS

CONFIGURATION



CONSTRUCTION TYPE 5

Function: 1-sided
 Description: Front button assembly with rear wall fastening with auto-adjusting fixing claws
 Applications: Wall or boarding door

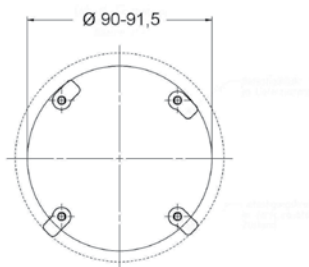
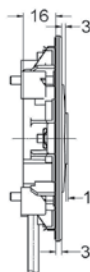
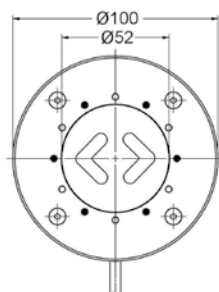

CK – Wall installation with fixing claws



CONSTRUCTION TYPE 6

Function: 1-sided
 Description: Front button assembly with front panel and visible screws
 Applications: Indoor or outdoor and for mounting on minimal depth

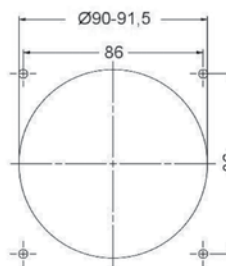
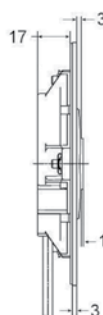
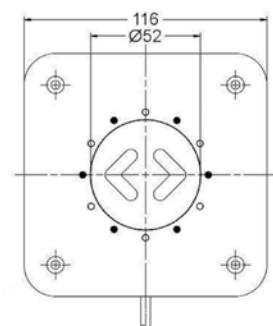

Visible front panel screws

Configuration Status "Construction and Mounting Types"



COLOR SELECTION FOR MOUNTING RINGS AND FRONT PANELS

Frequently used colors for CK mounting rings and CK front panels



TRAFFIC YELLOW
similar to RAL1023



LIGHT GRAY
similar to RAL7035



BRIGHT RED ORANGE
similar to RAL2008



TRAFFIC GRAY A
similar to RAL7042



TRAFFIC RED
similar to RAL3020



TRAFFIC GRAY B
similar to RAL7043



TRAFFIC BLUE
similar to RAL5017



TRAFFIC WHITE
similar to RAL9016



NIGHT BLUE
similar to RAL5022

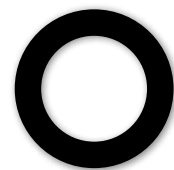

TRAFFIC BLACK
similar to RAL9017



TRAFFIC GREEN
similar to RAL6024



STAINLESS STEEL
matte shot-blasted

Configuration Status "Color Selection"











RAL colors are only for reference. Slight color deviations are inevitable in the manufacturing process.

LOOKING SHARP

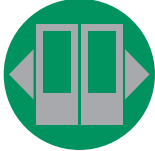
CONFIGURATION

PICTOGRAPHS

Commonly used graphic symbols for orientation, information, and guidance (more variants upon request).

	<p>B1 Silver background Blue symbol similar to RAL 5017</p>		<p>B61 Red background similar to RAL 3020 White symbol similar to RAL 9016</p>
	<p>B40 Blue background similar to RAL 5017 White symbol similar to RAL 9016</p>		<p>B26.2 Green background similar to RAL 6024 Silver symbol similar to RAL 9006</p>
	<p>B2 Blue background similar to RAL 5017 White symbol similar to RAL 9016</p>		<p>B71 Blue background similar to RAL 5017 Silver symbol similar to RAL 9006</p>
	<p>B11 Yellow background similar to RAL 1023 Black symbol similar to RAL 9017</p>		<p>B9 Yellow background similar to RAL 1023 Black symbol similar to RAL 9017</p>
	<p>B53 Black background similar to RAL 9017 White symbol similar to RAL 9016</p>		<p>B7 Yellow background similar to RAL 1023 Black symbol similar to RAL 9017</p>
	<p>B59.2 Blue background similar to RAL 5017 White symbol similar to RAL 9016</p>		<p>B34 Yellow background similar to RAL 1023 Black symbol similar to RAL 9017</p>

Configuration Status "Pictographs"



RAL colors are only for reference. Slight color deviations are inevitable in the manufacturing process.



B8
Yellow background similar to RAL 1023
Black symbol similar to RAL 9017



B46
Green background similar to RAL 6024
White symbol similar to RAL 9016



B12
Yellow background similar to RAL 1023
Black symbol similar to RAL 9017



B47
Red background similar to RAL 3020
White symbol similar to RAL 9016



B35
Yellow background similar to RAL 1023
Black symbol similar to RAL 9017



B28
Silver background similar to RAL 9006
Black symbol similar to RAL 9017



B39
Green background similar to RAL 6024
Black symbol similar to RAL 9017

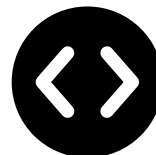

B55
Black background similar to RAL 9017
White symbol similar to RAL 9016



B84
Yellow background similar to RAL 1023
Black symbol similar to RAL 9017



B33
Blue background similar to RAL 5017
White symbol similar to RAL 9016



B31
Blue background similar to RAL 5017
White symbol similar to RAL 9016



B50
Yellow background similar to RAL 1023
Black symbol similar to RAL 9017

CONFIGURATION



B62
Red background similar to RAL 3020
White symbol similar to RAL 9016



B48
Blue background similar to RAL 5017
White symbol similar to RAL 9016



B30
Red background similar to RAL 3020
White symbol similar to RAL 9016



B60
Blue background similar to RAL 5017
White symbol similar to RAL 9016



B70
Night blue background similar to RAL 5022
Signal white symbol similar to RAL 9003



B54
Black background similar to RAL 9017
White symbol similar to RAL 9016



B66
Blue background similar to RAL 5017
White symbol similar to RAL 9016



B57
Black background similar to RAL 9017
White symbol similar to RAL 9016



B43
Blue background similar to RAL 5005
White symbol similar to RAL 9016



B64
Blue background similar to RAL 5017
White symbol similar to RAL 9016



B44
Blue background similar to RAL 5005
White symbol similar to RAL 9016



B51
Red background similar to RAL 3020
White symbol similar to RAL 9016

Configuration Status "Pictographs"





B56

Red background similar to RAL 3020

White symbol similar to RAL 9016



B69

Night blue background similar to RAL 5022

Signal white symbol similar to RAL 9003

STRAIGHTFORWARD

CONFIGURATION

TACTILE ACTIVATION SURFACE

Due to the modular design of the Combikey buttons, pictographs and tactile touch surfaces can be combined. Tactile symbols are subtly raised. Designs and sizes are in full compliance with EN14752 and TSI-PRM.



T00
Transparent button surface
without tactile symbol



T03
Transparent button surface
with tactile key (Lock)



T01
Transparent button surface
with tactile open arrows



T05
Transparent button surface
with tactile speaker (message)



T02
Transparent button surface
with tactile close arrows



T13
Transparent button surface
with tactile "Alarm"



T04
Transparent button surface
with tactile "i" as information symbol



T06
Transparent button surface
with tactile open and close arrows

Configuration Status "Tactile Symbols"



RAL colors are only for reference. Slight color deviations are inevitable in the manufacturing process.



T10
Transparent button surface
with tactile dot



T15
Transparent button surface
with Braille "ramp" (Grade-2 Braille)



T11
Transparent button surface
with two tactile dots



T07
Transparent button surface
with tactile "SOS"



T12
Transparent button surface
with three tactile dots



T09
Transparent button surface
with tactile "WC"



T14
Transparent button surface
with Braille "ope" (Grade-2 Braille)
and tactile open arrows



T08
Transparent button surface
with tactile cup symbol

FEEL THE
INFORMATION

CONFIGURATION

Some light and sound signal examples are presented on the following pages.

Different light and sound signals are triggered accordingly as programmed in the button. However, it is also possible to trigger functions by an external controller. For this purpose, the Combikey Series has three inputs; In1, In2, and In3.

To better exemplify, it is possible to disable the button during night hours, indicate a door out of service, or shut off the orientation tone at night. The possibilities are as varied as the application requirements.



The combination of light, sound, and input signals as well as the desired functionality of the output are custom-built.

The following tables show some of the many possibilities of the Combikey Series. Each table stands for a custom-made button parameter, and it describes the light and sound of each operational status.

LIGHT AND SOUND SIGNALS

The Combikey Series offers a wide variety of light and sound signals. The following table shows a selection of standard versions. Other variations are available upon request.

LIGHT SIGNALS

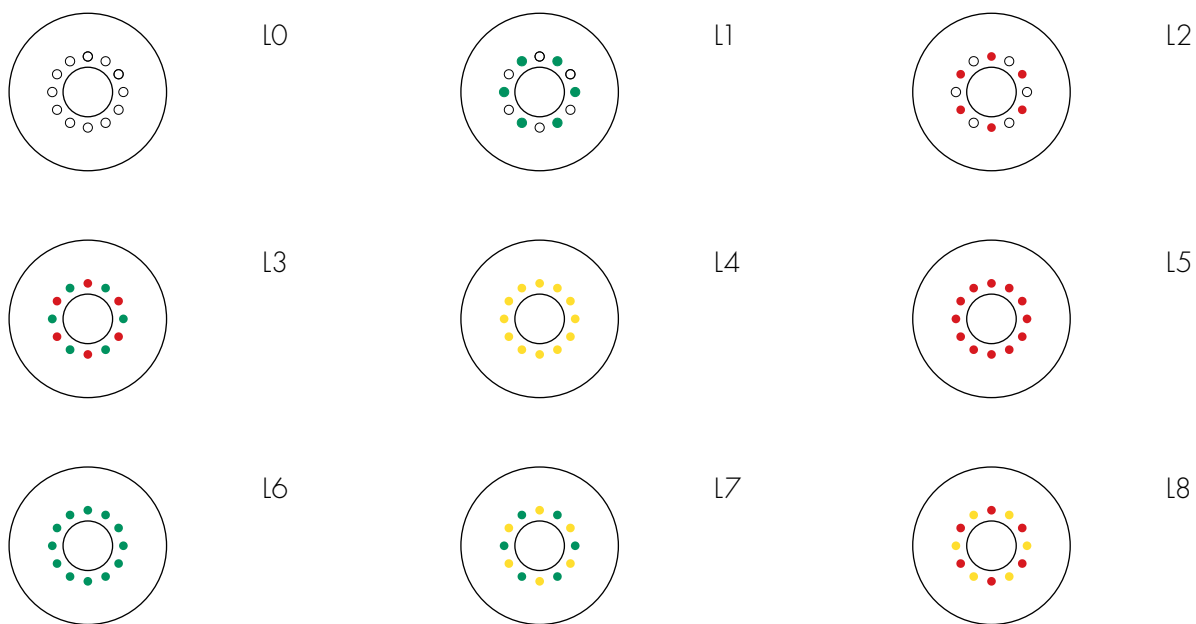

SOUND SIGNALS

The maximum sound pressure of the CK is 53dBA at one meter distance.

	A0	A1	A2	A3
Tone frequency:	-	3.5 kHz	3.8 kHz	3.5 kHz
Tone length:	-	0.5 sec.	0.05 sec.	Unlimited
Interval:	-	1-time	0.5 Hz	-
Description:	-	Confirmation	Orientation	Prolonged

Configuration Status "Light and Sound Signals"



SEE AND HEAR THE BUTTON

CONFIGURATION

CONFIGURATION EXAMPLES

PROGRAM A10 – BUTTON FUNCTION 1-SIDED

INPUT				ENABLE			ACTIVATED			DISCRIPTION
IN 1	IN 2	IN 3	UB	LED	TON	OUT	LED	TON	OUT	
0	-	-	0	L0	A0	-	L0	A0	-	<ul style="list-style-type: none"> · 6 green and 6 red LEDs · 4 connection cables · Button activation with UB · Red LEDs are internally wired · Sound signals are internally wired · Green LEDs are connected via PLC In1
0	-	-	1	L0	A0	-	L2	A1	Ein	
1	-	-	1	L1	A0	-	L3	A1	Ein	
1	-	-	0	L0	A0	-	L0	A0	-	

PROGRAM A7 – BUTTON FUNCTION DOUBLE-SIDED

INPUT				ENABLE			ACTIVATED			DISCRIPTION
IN 1	IN 2	IN 3	UB	LED	TON	OUT	LED	TON	OUT	
0	-	-	0	L0	A0	-	L0	A0	-	<ul style="list-style-type: none"> · 6 green and 6 red LEDs · 4 connection cables · Button activation with UB · Red LEDs are internally wired · Green LEDs are connected via PLC In1
0	-	-	1	L0	A0	-	L2	A0	Ein	
1	-	-	1	L1	A0	-	L3	A0	Ein	
1	-	-	0	L0	A0	-	L0	A0	-	

PROGRAM A8 – BUTTON FUNCTION 1-SIDED

INPUT				ENABLE			ACTIVATED			DISCRIPTION
IN 1	IN 2	IN 3	UB	LED	TON	OUT	LED	TON	OUT	
0	-	-	0	L0	A0	-	L0	A0	-	<ul style="list-style-type: none"> · 6 green and 6 red LEDs · 4 connection cables · Button activation with UB · Red LEDs are internally wired · Green LEDs are connected via PLC In1
0	-	-	1	L0	A0	-	L2	A0	Ein	
1	-	-	1	L1	A0	-	L3	A0	Ein	
1	-	-	0	L0	A0	-	L0	A0	-	

PROGRAM H8 - BUTTON FUNCTION DOUBLE-SIDED

INPUT				ENABLE			ACTIVATED			DISCRIPTION
IN 1	IN 2	IN 3	UB	LED	TON	OUT	LED	TON	OUT	
0	0	0	0	L0	A0	-	L0	A0	-	<ul style="list-style-type: none"> · 12 green, 12 red and 12 yellow LEDs · 6 connection cables · Button activation with UB · Green LEDs are connected via PLC In1 · Yellow LEDs are connected via PLC In2 · Red LEDs are connected via PLC In3 · Audio signals are internally wired · No mixed colors possible · green/yellow/red separately switchable
0	0	0	1	L0	A0	-	L0	A1	Ein	
1	0	0	1	L6	A0	-	L6	A1	Ein	
0	1	0	1	L4	A0	-	L4	A1	Ein	
0	0	1	1	L5	A0	-	L5	A1	Ein	
1	1	0	1	L0	A0	-	L0	A1	Ein	
0	1	1	1	L0	A0	-	L0	A1	Ein	
1	0	1	1	L0	A0	-	L0	A1	Ein	
1	1	1	1	L0	A0	-	L0	A1	Ein	

PROGRAM A9 - BUTTON FUNCTION DOUBLE-SIDED

INPUT				ENABLE			ACTIVATED			DISCRIPTION
IN 1	IN 2	IN 3	UB	LED	TON	OUT	LED	TON	OUT	
0	0	0	0	L0	A0	-	L0	A0	-	<ul style="list-style-type: none"> · 6 green and 6 red interior LEDs · 6 green and 6 red exterior LEDs · 6 connection cables · Button activation with UB · Green interior LEDs are connected via PLC In1 · Red LEDs are connected via PLC In2 · Green exterior LEDs are connected via PLC In 3
0	0	0	1	L0	A0	-	L0	A0	Ein	
1	0	0	1	L1	A0	-	L0	A0	Ein	
0	1	0	1	L2+L2	A0	-	L2+L2	A0	Ein	
0	0	1	1	L1	A0	-	L1	A0	Ein	
1	1	0	1	L3+L2	A0	-	L3+L2	A0	Ein	
0	1	1	1	L3+L2	A0	-	L3+L2	A0	Ein	
1	0	1	1	L1	A0	-	L1	A0	Ein	
1	1	1	1	L3+L3	A0	-	L3+L3	A0	Ein	

Configuration Status "Button Function"



CONNECTIVITY

PIN ASSIGNMENT FOR PLUG NO. 65

PIN	1	2	3	4	5	6	Appearance
Color	Brown	White	Blue	Black	Gray	na	
Signal	+UB	In 1	Gnd (0V)	Out	In 2	-	
Number of poles	6						
Plug type	Rectangular plug, MATE-N-LOK®						
Cable	Radox TENUIS, TW / S5F® 5x0.5 mm						
Manufacturer	TYCO Electronics / AMP, 794895-1						
Protection level	IP67						
Cable length	10 cm						

PIN ASSIGNMENT FOR PLUG NO. 64

PIN	1	2	3	4	Appearance
Color	Brown	White	Blue	Black	
Signal	+UB	In 1	Gnd (0V)	Out	
Number of poles	4				
Plug type	Rectangular plug, MATE-N-LOK®				
Cable	Radox TENUIS, TW / S4F® 4x0.5 mm				
Manufacturer	TYCO Electronics / AMP, 794805-1 corresponds BN65074				
Protection level	IP67				
Cable length	10 cm				

PIN ASSIGNMENT FOR PLUG NO. 61

PIN	1	2	3	4	5	6	Appearance
Color	Brown	White	Blue	Black	Gray	Red	
Signal	+UB	In 1	Gnd (0V)	Out	In 2	In 3	
Number of poles	4-8						
Plug type	Circular connector, M12x1 screw						
Cable	Radox TENUIS, TW / S-F® 4-6x0.5 mm						
Manufacturer	ESCHA M12x1, 4-, 5-, 6-polig WAS4...WAS6						
Protection level	IP67						
Cable length	50 cm						

Note: 6 and 8 pole versions only allow for operating voltage <60V

PIN ASSIGNMENT FOR PLUG NO. 60

PIN	1	2	3	4	Appearance
Color	Brown	White	Blue	Black	
Signal	+UB	In 1	Gnd (0V)	Out	
Number of poles	4				
Plug type	Circular Connectors, combined snap-in snap-lock M8x1 screw and corresponding BN 65074				
Cable	Radox TENUIS, TW / S4F® 4x0.5 mm				
Manufacturer	ESCHA diameter 8mm M8x1 (SSFP4), 4-pole, SSP4				
Protection level	IP67				
Cable length	10 cm				

Note: 6 and 8 pole versions only allow for operating voltage <60V

CONNECTION DIAGRAM PNP

6-Wire type

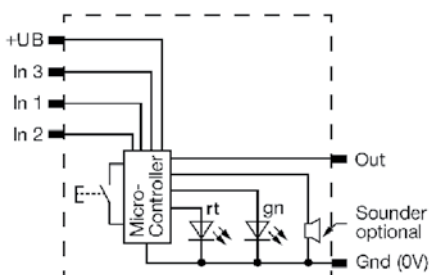

5-Wire type

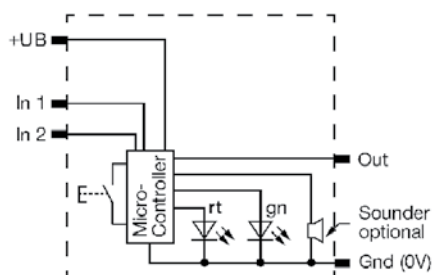

4-Wire type

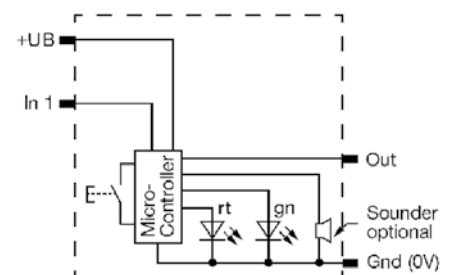



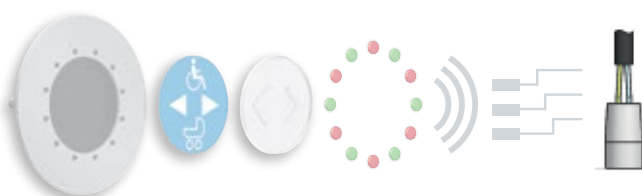



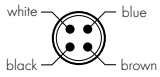

Configuration Status "Connection"

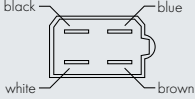

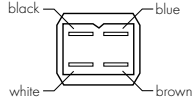

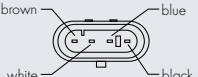
ADDITIONAL CONNECTORS AND TECHNICAL DATA

Plug nr.	Discription	Poles	Manufacturer	Appearance
0	Circular connectors	4	TYCO Electronics/AMP ArtNr.: 0-0925 0750-0	 
1	Flat connectors FASTIN-FASTON	4	TYCO Electronics/AMP ArtNr.: 180901	 
2	Flat connector FASTIN-FASTON	4	TYCO Electronics/AMP 626 057	 
66	SUPERSEAL connector	4	TYCO Electronics/AMP 2821061-1	 
71	Rectangular plug	4	GERMAN DTM044P-4P	 

TECHNICAL DATA

Electrical Data		Mechanical Data		Environmental Conditions	
Nominal voltage	24 VDC, 36VDC, 72 VDC, 110 VDC	Housing material and button surface	UV-Stabilized Poly- carbonate (UL94 V-0)	Operating life	Approx. 7,000,000 press cycles
Operating voltage	Refer to nominal voltage +/-30%	Zentraflexring	NBR (Nitrile Butadiene Rubber)	Operating temperature	-40°C to +80°C
Nominal current	Max. 50 mA or 200 mA	Mounting ring	V2A, Powder-coated	Protection level	Waterproof front IP67 EN60529 approved
Operating current	Approx. 10 mA	Button diameter	Refer to construction type section (p. 6)		
Switching output	PNP or NPN	Activation force	Approx. 7.5 - 9N Length approx. 0.15mm		
		Connection options	Refer to connections section (p. 20)		



At TSL Downloads!

TSL-ESCHA GmbH

Elberfelder Str. 1 | 58553 Halver | Germany
Tel.: +49 2353 66796-0 | Fax: +49 2353 66796-799

TSL S.A.

Rue du Stand 63 | 2800 Delémont | Switzerland
Tel.: +41 32 4244-701 | Fax: +41 32 4244-799

info@tsl-escha.com · www.tsl-escha.com

TOUCH IT

TSL - a member of the TURCK Group

